

Example splash page on a desktop (created via bookmap?)

Logo links to SE.com

Categorized information (we'd probably use users)

What's new, featured topics, release notes, etc.

Search front and centre

More graphical high-level TOC

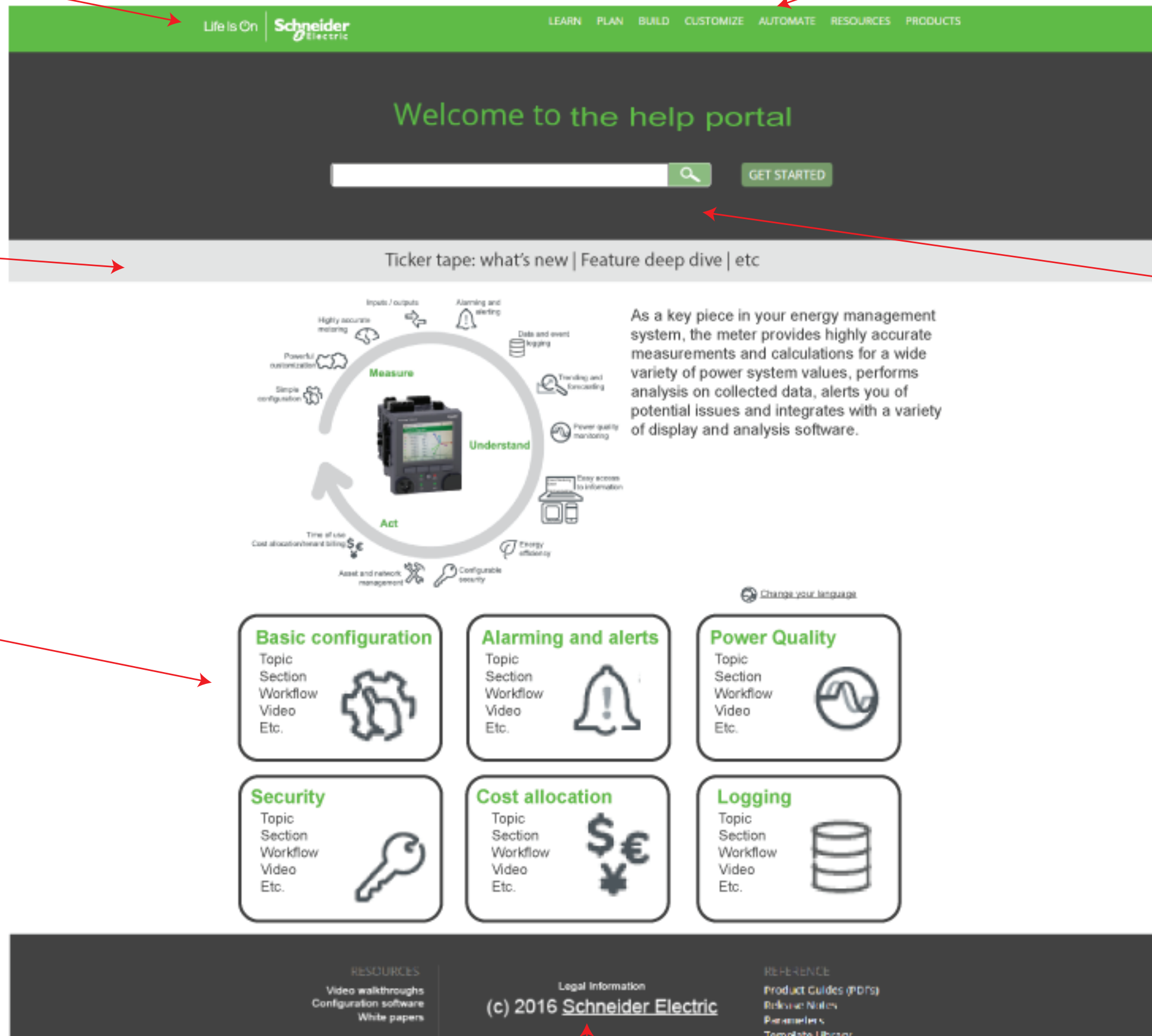

Links to SE.com, contact info, legal info

Example topic page on desktop

Logo links to SE.com

Life is On | Schneider Electric

LEARN PLAN BUILD CUSTOMIZE AUTOMATE RESOURCES PRODUCTS

Link back to splash page always available

Search

Search still very prominent NTH: with ability to filter on keywords

Categorized information (we'd probably use users)

CUSTOMIZE > Creating custom displays using ION Setup

Watch I read later

Change your language

CUSTOMIZE

Creating custom displays using ION Setup

Creating custom webpages

Creating custom schedules

Etc.

Ability for the user to see where they are in a workflow (generated from map) Alternative to old-school TOC

Reader can choose to bookmark a topic

Creating custom displays using ION Setup

You can use ION Setup to program new custom displays.

1. Start ION Setup.

2. Open the Setup Assistant for your meter.

3. Navigate to Custom Displays.

4. Select Custom Displays from the Front Panel tab and click Edit. ION Setup loads your meter's display information into the Display Editor screen.

5. Rename, delete, or change the order of custom displays through the Display Editor screen. Click New to add a new display. Click Edit to bring up the Display setup screen, where you can configure new or existing custom displays.

6. Configure your screen.

Screen Type: Specify the number of parameters displayed on the screen.

Screen Title: Enter the title to be shown at the top of your custom display.

7. Click Edit to select the displayed parameters. The number of parameters displayed is determined in the Screen Type selection described above.

8. Select your digit display properties.

Resolution: Specifies the number of decimal places displayed.

Last Digit: Enter the title to be shown at the top of your custom display.

9. Click Send to save the changes in the meter.

This is where related topics would appear

RESOURCES

Video walkthroughs

Configuration software

White papers

Legal Information

(c) 2016 Schneider Electric

REFERENCE

Product Guides (PDFs)

Release Notes

Parameters

Template Library

Links to SE.com, contact info, legal info

Example topic page on mobile

Logo links to SE.com

Categorized information moves into hamburger menu

Search still very prominent
NTH: with ability to filter on keywords with example

Link back to splash
page always available



Reader can change language or bookmark a topic

breadcrumbs

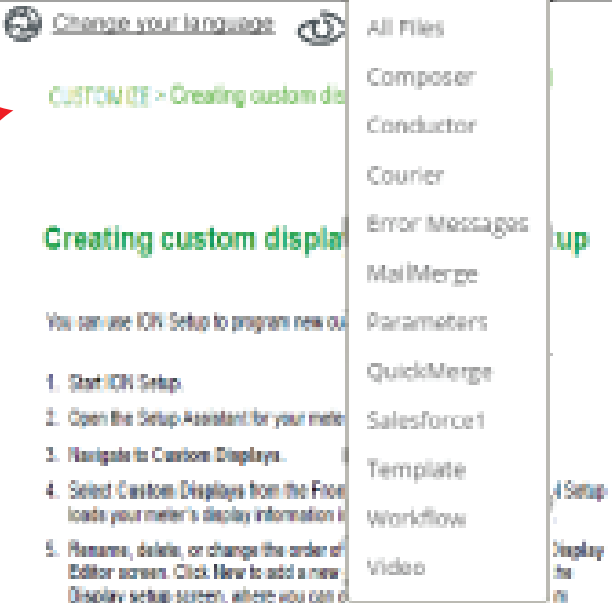

This is where related topics
would appear

Links to SE.com, contact info, legal info would be in hamburger or at end of scrolling through topic